



AUSTRALIS®  
CAPE HORN & PATAGONIA

M/V VENTUS AUSTRALIS - M/V STELLA AUSTRALIS

# Rates & Departures

Season 2021 - 2022



- Embarkation ports
- Excursion sites
- Other highlights of Patagonia
- Panoramic navigation

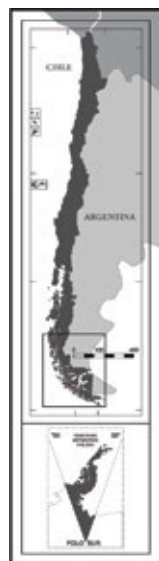

# RATES AND DEPARTURES · 2021 - 2022

(Rates in US Dollar per person, based on double occupancy)

Rates (4 nights)	Cabin	Promotional	Low	High
	B	1.590	1.990	2.590
	A	2.162	2.670	3.499
	AA	2.253	2.790	3.720
	AAA	2.371	2.990	3.989
	AA Superior	2.794	3.474	4.485
	AAA Superior	2.915	3.628	4.750

Rates are subject to cabin availability, Individual rates: Applies to all cabin types and corresponds to an additional 50% of the category value.

## Departures Punta Arenas - Ushuaia

M/V VENTUS AUSTRALIS

September 2021					25
October 2021	3	11	19	27	
November 2021	4	12	20	28	
December 2021	6	14	22	30	
January 2022	7	15	23	31	
February 2022	8	16	24		
March 2022	4	12	20	28	
April 2022	5				

Boarding time: 06:00 PM | Disembarking time: 08:30 AM

## Departures Ushuaia - Punta Arenas

M/V VENTUS AUSTRALIS

September 2021					29
October 2021	7	15	23	31	
November 2021	8	16	24		
December 2021	2	10	18	26	
January 2022	3	11	19	27	
February 2022	4	12	20	28	
March 2022	8	16	24		
April 2022	1	9			

Boarding time: 06:00 PM | Disembarking time: 11:30 AM

## Departures Punta Arenas - Ushuaia

M/N STELLA AUSTRALIS

September 2021					
October 2021			23	31	
November 2021	8	16	24		
December 2021	2	10	18	26	
January 2022	3	11	19	27	
February 2022	4	12	20	28	
March 2022	8	16	24		
April 2022					

Boarding time: 06:00 PM | Disembarking time: 08:30 AM

## Departures Ushuaia - Punta Arenas

M/V STELLA AUSTRALIS

September 2021					
October 2021				27	
November 2021	4	12	20	28	
December 2021	6	14	22	30	
January 2022	7	15	23	31	
February 2022	8	16	24		
March 2022	4	12	20	28	
April 2022					

Boarding time: 06:00 PM | Disembarking time: 11:30 AM

## ROUTES & ITINERARIES



### Fjords of Tierra del Fuego Punta Arenas - Ushuaia · 4 nights

M/V Ventus Australis | M/V Stella Australis  
Excursions per trip: 5

**Day 1:** Punta Arenas

**Day 2:** Ainsworth Bay - Tuckers Islets\*

**Day 3:** Pia Glacier - Glaciers Alley\*\*

**Day 4:** Cape Horn - Wulaia Bay

**Day 5:** Ushuaia

\*In September and April this excursion is replaced by Brookes Glacier.  
\*\*Not an excursion.



### Patagonian Explorer Ushuaia - Punta Arenas · 4 nights

M/V Ventus Australis | M/V Stella Australis  
Excursions per trip: 7

**Day 1:** Ushuaia

**Day 2:** Cape Horn - Wulaia Bay

**Day 3:** Pia Glacier - Porter Glacier

**Day 4:** Condor Glacier - Aguila Glacier

**Day 5:** Magdalena Island\* - Punta Arenas

\*In September and April this excursion is replaced by Marta Island.



Excursions subject to weather conditions  
For more information about routes and itineraries visit [www.australis.com](http://www.australis.com)



# M/V VENTUS AUSTRALIS - M/V STELLA AUSTRALIS



**Passenger Capacity 200**

**Total Cabins 100**

## Cabin Plan

- Standard: 177 sq.ft. / 16,5 m<sup>2</sup>

- Superior: 220 sq.ft. / 20,5 m<sup>2</sup>

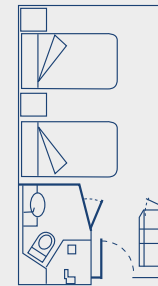

**Standard**

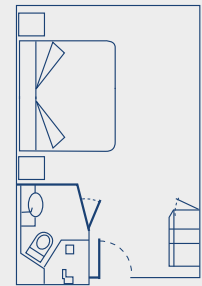

**Superior**

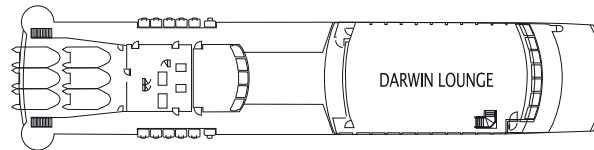

DARWIN DECK

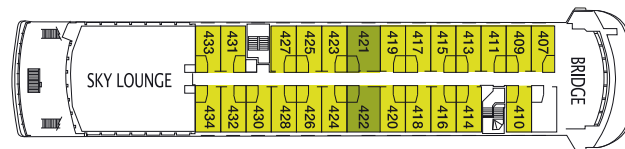

CABO DE HORNOS DECK

AAA

AAA SUPERIOR

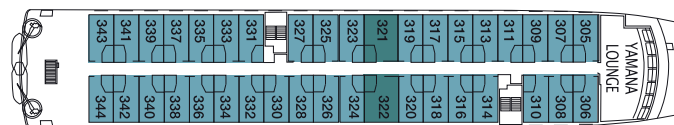

TIERRA DEL FUEGO DECK

AA

AA SUPERIOR

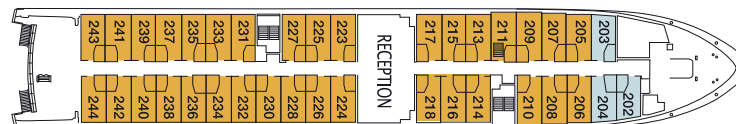

MAGALLANES DECK

A

B



PATAGONIA DECK

# CONDITIONS

## PASSAGE CONTRACT

Buying a ticket implies entering into an agreement under the terms and conditions of the Owner (here and after "the Company") for passenger transportation.

## RESERVATIONS, DEPOSITS AND PAYMENTS

A deposit of US\$ 300 per passenger is required to guarantee a tentative reservation. The final payment must be received by the Company 60 days before the departure of the cruise.

## CANCELLATION POLICY

The following penalties will apply in case of cancellation as soon as the Company receives written notice.

### Notice

Up to 120 days before departure  
From 119 and 60 days before departure  
From 59 and 50 days before departure  
From 49 and 40 days before departure  
From 39 and 30 days before departure  
From 29 and 0 days before departure

### Fine

US\$0.-  
US\$300.- (Deposit).  
25% of sales value.  
50% of sales value.  
75% of sales value.  
100% of sales value.

## CHILDREN POLICY

Infants between 0 and 3 years old have a 100% discount, sharing the bed with their parents. Children between 4 and 12 years old have a 50% discount, sharing a cabin with an adult.

## RATES & DEPARTURES

The Company reserves the right to modify the cruise rates and departure dates published in this brochure, without prior notice.

The time of departure and arrival are approximate, the vessel may be delayed, without any responsibility for the Company due to climate conditions.

## TRAVEL CONDITIONS

Rates include accommodation, sea transportation, all meals, open bar when on duty (without additional cost for wines, beverages, and liquors), shore excursions, and onboard entertainment.

Optional tours and transportation are not included in the cruise rate. Rate does not include port tax, migration fee, and national park fee. The cost per person is the following:

Punta Arenas - Ushuaia route:	US\$ 75.- (dollars/pax)
Ushuaia - Punta Arenas route:	US\$ 75.- (dollars/pax)
Punta Arenas - Ushuaia - Punta Arenas route:	US\$ 85.- (dollars/pax)
Ushuaia - Punta Arenas - Ushuaia route:	US\$ 85.- (dollars/pax)

These costs may be modified by the port authorities of each country.

## FORMS OF PAYMENT

Mastercard, Visa, American Express, and Diners credit cards, traveler's checks, US Dollars, Euros, Chilean Pesos, PayPal (payment in dollars), and Transbank (payment in Chilean pesos) are accepted.

## REQUIRED CLOTHING

Waterproof clothing and waterproof trekking shoes or hiking boots.

## NOTE

While we try and operate our cruise itineraries and shore excursions as described in this brochure, we reserve the right to alter, change, or omit any part of this itinerary or excursion without prior notice due to health and safety concerns for our passengers, proper preservation of the environment, or any other circumstance, fortuitous event or force majeure that requires it.

Likewise, while birds and animals are abundant in the region, we cannot guarantee specific sightings due to the unpredictability of nature.

