



AUSTRALIS®
CAPE HORN & PATAGONIA

M/V STELLA AUSTRALIS - M/V VENTUS AUSTRALIS

Rates & Departures

September 2020 - April 2021



www.australis.com



Rates & Departures · September 2020 - April 2021

(Rates in US Dollar per person, based on double occupancy cabin)

| Rates (4 nights) | Cabin | Promotional | Low | High |
|------------------|-------------|-------------|-------|-------|
| | B | 1.590 | 1.990 | 2.590 |
| | A | 2.162 | 2.670 | 3.499 |
| | AA | 2.253 | 2.790 | 3.720 |
| | AAA | 2.371 | 2.990 | 3.989 |
| | AA Superior | 2.794 | 3.474 | 4.485 |
| AAA Superior | 2.915 | 3.628 | 4.750 | |

| Rates (8 nights) | Cabin | Promotional | Low | High |
|------------------|-------------|-------------|-------|-------|
| | B | 2.862 | 3.582 | 4.662 |
| | A | 3.892 | 4.806 | 6.299 |
| | AA | 4.056 | 5.022 | 6.696 |
| | AAA | 4.268 | 5.382 | 7.181 |
| | AA Superior | 5.030 | 6.254 | 8.073 |
| AAA Superior | 5.247 | 6.531 | 8.550 | |

Rates are "starting from", and only for a limited cabin stock per departure. PER PASSENGER RATES: Applies to all cabin types and corresponds to an additional 50% of the category value.

Departures Punta Arenas - Ushuaia

M/V STELLA AUSTRALIS (4 NIGHTS)

| | | | | | |
|-----------|------|---|----|----|----|
| September | 2020 | | | | |
| October | 2020 | | | 19 | 27 |
| November | 2020 | 4 | 12 | 20 | 28 |
| December | 2020 | 6 | 14 | 22 | 30 |
| January | 2021 | 7 | 15 | 23 | 31 |
| February | 2021 | 8 | 16 | 24 | |
| March | 2021 | 4 | 12 | 20 | |
| April | 2021 | | | | |

Boarding time: 06:00 PM | Disembarkin time: 08:30 AM

Departures Ushuaia - Punta Arenas

M/V STELLA AUSTRALIS (4 NIGHTS)

| | | | | | |
|-----------|------|---|----|----|----|
| September | 2020 | | | | |
| October | 2020 | | | 23 | 31 |
| November | 2020 | 8 | 16 | 24 | |
| December | 2020 | 2 | 10 | 18 | 26 |
| January | 2021 | 3 | 11 | 19 | 27 |
| February | 2021 | 4 | 12 | 20 | 28 |
| March | 2021 | 8 | 16 | 24 | |
| April | 2021 | | | | |

Boarding time: 06:00 PM | Disembarkin time: 11:30 AM

Departures Punta Arenas - Ushuaia

M/V VENTUS AUSTRALIS (4 NIGHTS)

| | | | | | |
|-----------|------|---|----|----|----|
| September | 2020 | | | 21 | 29 |
| October | 2020 | 7 | 15 | 23 | 31 |
| November | 2020 | 8 | 16 | 24 | |
| December | 2020 | 2 | 10 | 18 | 26 |
| January | 2021 | 3 | 11 | 19 | 27 |
| February | 2021 | 4 | 12 | 20 | 28 |
| March | 2021 | 8 | 16 | 24 | |
| April | 2021 | 1 | | | |

Boarding time: 06:00 PM | Disembarkin time: 08:30 AM

Departures Ushuaia - Punta Arenas

M/V VENTUS AUSTRALIS (4 NIGHTS)

| | | | | | |
|-----------|------|---|----|----|----|
| September | 2020 | | | | 25 |
| October | 2020 | 3 | 11 | 19 | 27 |
| November | 2020 | 4 | 12 | 20 | 28 |
| December | 2020 | 6 | 14 | 22 | 30 |
| January | 2021 | 7 | 15 | 23 | 31 |
| February | 2021 | 8 | 16 | 24 | |
| March | 2021 | 4 | 12 | 20 | 28 |
| April | 2021 | 5 | | | |

Boarding time: 06:00 PM | Disembarkin time: 11:30 AM

Routes & Itineraries



Fjords of Tierra del Fuego Punta Arenas - Ushuaia · 4 nights

M/V Ventus Australis | M/V Stella Australis
Excursions per trip: 5

- Day 1:** Punta Arenas
- Day 2:** Ainsworth Bay - Tuckers Islets*
- Day 3:** Pia Glacier - Glaciers Alley**
- Day 4:** Cape Horn - Wulaia Bay
- Day 5:** Ushuaia

*In September and April this excursion is replaced by Brookes Glacier.
**Not an excursion.



Patagonian Explorer Ushuaia - Punta Arenas · 4 nights

M/V Ventus Australis | M/V Stella Australis
Excursions per trip: 7

- Day 1:** Ushuaia
- Day 2:** Cape Horn - Wulaia Bay
- Day 3:** Pia Glacier - Garibaldi Glacier*
- Day 4:** Condor Glacier - Aguila Glacier
- Day 5:** Magdalena Island** - Punta Arenas

*This excursion can be replaced with Porter Glacier.
**In September and April this excursion is replaced by Marta Island.



M/V Stella Australis - M/V Ventus Australis



Patagonia Dining Room



Sky Lounge



Yamana Lounge



Superior cabin Ventus Australis

Passenger Capacity 200

Total Cabins 100

Cabin Plan

- Standard: 177 sq.ft. / 16,5 m²

- Superior: 220 sq.ft. / 20,5 m²

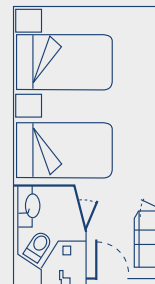

Standard

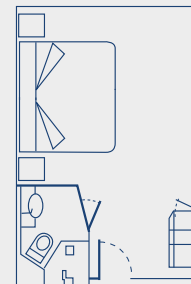

Superior

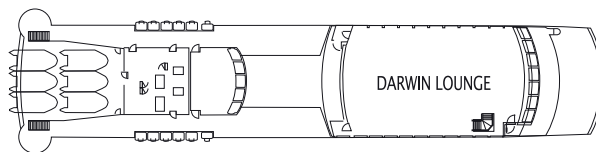

DARWIN DECK

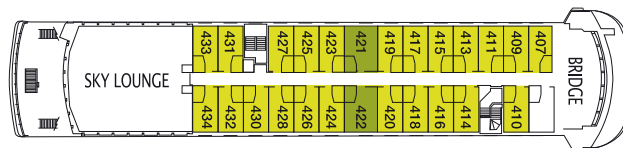

CABO DE HORNOS DECK

AAA
AAA SUPERIOR

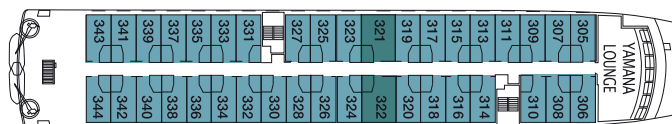

TIERRA DEL FUEGO DECK

AA
AA SUPERIOR

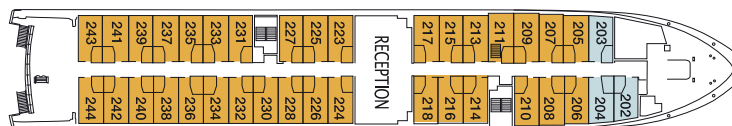

MAGALLANES DECK

A B



PATAGONIA DECK

Conditions

PASSAGE CONTRACT

Buying a ticket implies entering into an agreement under the terms and conditions of the Owner (here and after "the Company") for passenger transportation.

RESERVATIONS, DEPOSITS AND PAYMENTS

A deposit of US\$ 300 per passenger is required to guarantee a tentative reservation. The final payment must be received by the Company 60 days before the departure of the cruise.

CANCELLATION POLICY

The following penalties will apply in case of cancellation as soon as the Company receives written notice.

Notice

Up to 120 days before departure
From 119 and 60 days before departure
From 59 and 50 days before departure
From 49 and 40 days before departure
From 39 and 30 days before departure
From 29 and 0 days before departure

Fine

US\$0.-
US\$300.- (Deposit).
25% of sales value.
50% of sales value.
75% of sales value.
100% of sales value.

CHILDREN POLICY

Infants between 0 and 3 years old have a 100% discount, sharing the bed with their parents. Children between 4 and 12 years old have a 50% discount, sharing a cabin with an adult.

RATES & DEPARTURES

The Company reserves the right to modify the cruise rates and departure dates published in this brochure, without prior notice.

The time of departure and arrival are approximate, the vessel may be delayed, without any responsibility for the Company due to climate conditions.

CRUISE CONDITIONS

Rates include accommodation, sea transportation, all meals, open bar when on duty (without additional cost for wines, beverages, and liquors), shore excursions, and onboard entertainment.

Optional tours and transportation are not included in the cruise rate. Rate does not include port tax, migration fee, and national park fee. The cost per person is the following:

| | |
|--|-------------------------|
| Punta Arenas - Ushuaia route: | US\$ 75.- (dollars/pax) |
| Ushuaia - Punta Arenas route: | US\$ 75.- (dollars/pax) |
| Punta Arenas - Ushuaia - Punta Arenas route: | US\$ 85.- (dollars/pax) |
| Ushuaia - Punta Arenas - Ushuaia route: | US\$ 85.- (dollars/pax) |

These costs may be modified by the port authorities of each country.

FORMS OF PAYMENT

Mastercard, Visa, American Express, and Diners credit cards, traveler's checks, US Dollars, Euros and Chilean Pesos are accepted.

REQUIRED CLOTHING

Trekking or hiking shoes are required for all passengers.

